

READ THIS BEFORE USING YOUR P90X® CHIN-UP BAR

Due to the physical nature of using this equipment, Beachbody recommends a complete physical examination from your physician before beginning any exercise program. If you experience any discomfort while using the P90X Chin-Up Bar, discontinue use and consult your physician.

The P90X Chin-Up Bar is a serious workout tool that should ONLY be used to perform chin-up and pull-up exercises. It has been designed to fit residential doorways 24" to 32" wide and support up to 300 pounds. While this product has been manufactured and tested to decrease the risk of injury, the potential for personal injury or property damage does exist. Therefore, the user assumes all risks in the use of this product.

IMPORTANT: Before using this piece of equipment, make absolutely certain it is securely and correctly mounted in a doorway of appropriate size. If the doorway foundation is not strong and stable, **DO NOT USE** this product in that location. It is the user's responsibility to determine if a doorway will safely sustain the proper use of the P90X Chin-Up Bar.

With a total of 12 separate grip locations, the P90X Chin-Up Bar gives you the option to perform a variety of pull-ups using different hand positions, targeting different muscles and areas of the body. However, in every instance, your body should be pulled up in a straight and controlled motion.

Important Safety Reminders

- DO NOT swing or bounce when using this product.
- DO NOT attempt to hang by your feet or legs when using this product.
- DO NOT use this product if you weigh over 300 pounds.
- DO NOT use this product if you are unsure of the stability of the doorway or doorjamb.
- DO NOT allow children under the age of 18 to use this product without adult or professional supervision.
- DO test thoroughly to make sure your P90X Chin-Up Bar is completely secure in the doorway before using it.
- DO maintain a controlled motion when performing chin-ups.

Beachbody's P90X workouts specify using a chin-up bar for the following exercises:

- Wide Front Pull-Ups
- Reverse Grip Chin-Ups
- Closed Grip Overhand Pull-Ups
- Switch Grip Pull-Ups
- Corn Cob Pull-Ups

See your P90X Fitness Guide for specific instructions.

© 2007 Beachbody. All rights reserved.

Product Partners, LLC, is the owner of P90X, Beachbody, Million Dollar Body, and all related designs and trademarks. Distributed by Product Partners, LLC, Beverly Hills, CA 90211

If you are a member of the Million Dollar Body™ community, contact your Coach for information and support or log in at MillionDollarBody.com.

For Beachbody and Million Dollar Body Customer Service, please call 1 (800) 818-5174 or go to Beachbody.com.

P90X® CHIN-UP BAR

Usage Guide and Safety Reminders



BEACHBODY
Get Results!™

P90X[®] Chin-Up Bar Instruction Sheet

Assembly inventory:

-  A: qty: 8
Wall anchor
-  B: qty: 8
Wall screw
-  C: qty: 10
Nut
-  D: qty: 8
Screw
-  E: qty: 2
Screw
-  F: qty: 2
Door "J" bracket

P90X Chin-Up Bar assembly:

Start Here Easy Setup Instructions

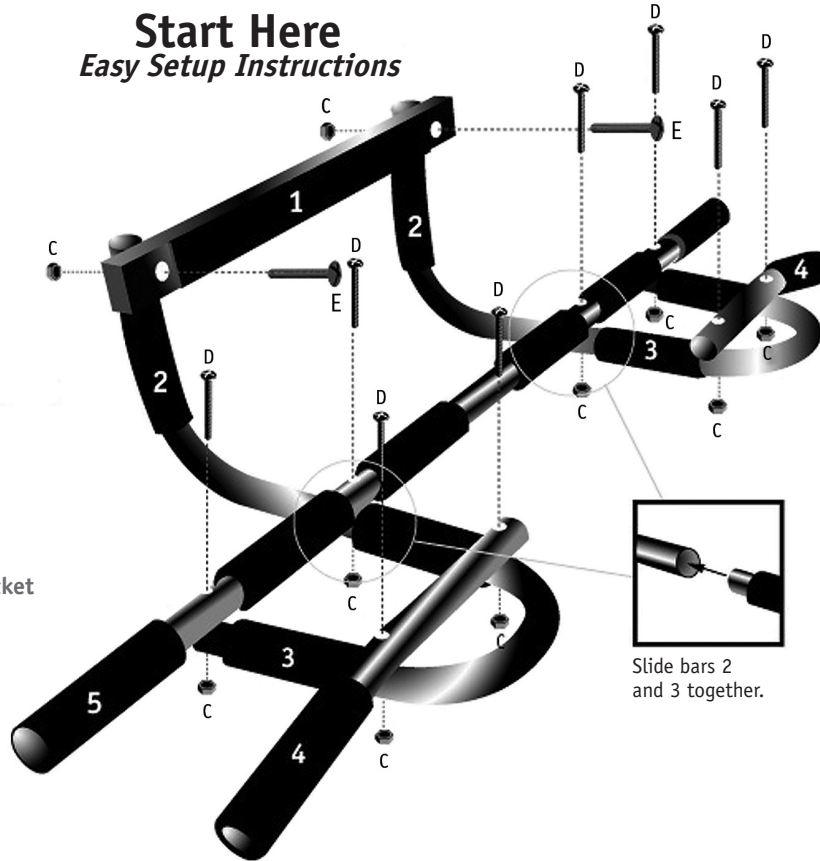

Slide bars 2 and 3 together.

Door "J" bracket mounting:

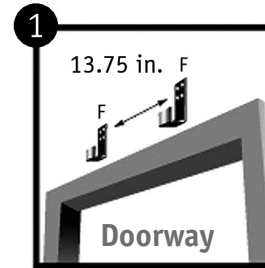

Center door "J" brackets and mark holes.

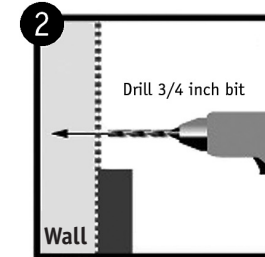

Drill holes into marks for wall anchors. Use a 3/4 drill bit.

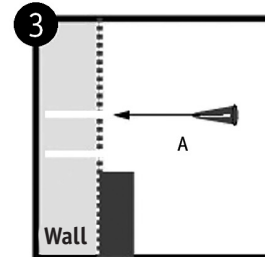

Place wall anchors.

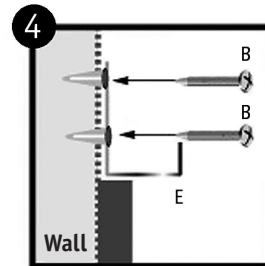

Position door "J" brackets and fasten into place.

P90X Chin-Up Bar mounting:

Door "J" bracket assembly:

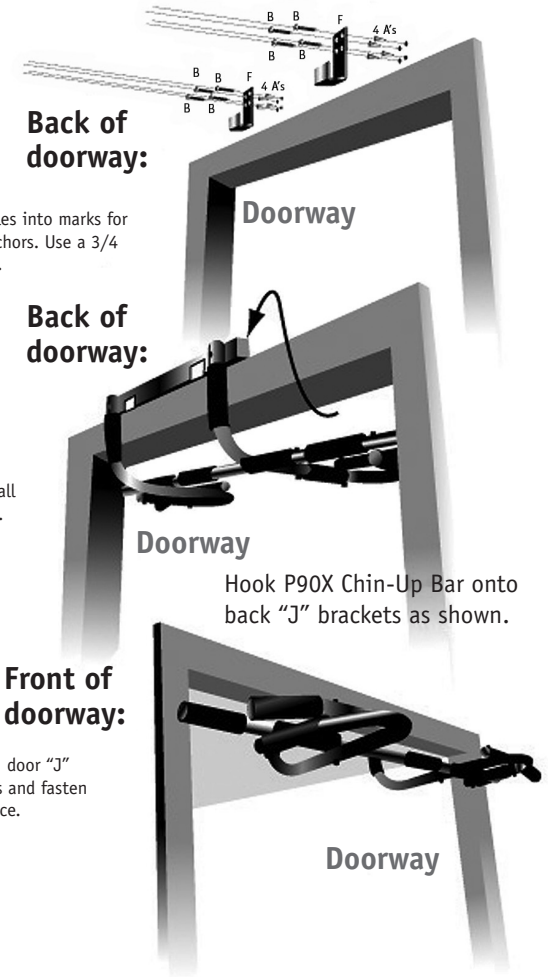

Back of doorway:

Back of doorway:

Front of doorway:

Hook P90X Chin-Up Bar onto back "J" brackets as shown.



BEACHBODY[®]

Get Results![™]